

Assembly guide & care instruction.

Soundwave® collection

OFFECCT

Important information to assure good assembly results.

- All walls must be dry (at least 1 week from painting) and clean before assemble the Velcro.
 - No wet or dry chemicals can be on wall surface.
 - Walls towards outside are not recommended if they are wet and cold.
 - Walls that are old and are effected with nicotine from cigarettes have to be carefully leaned or repainted before assemble.
 - The glue on the Velcro will be destroyed by silicon products, hand lotion etc. Do not touch the glue while assemble.
 - For brick walls or very uneven walls a flat surface material must be attached before assemble.
 - If the wall is uneven, a staple gun can be used. Staple the Velcro onto the wall, using two staples per Velcro attachment.
 - Avoid high temperatures from lights or heating system which can cause the glue on the Velcro to melt.
 - Soundwave® panels are not developed to be attached to sealing.
-

Five steps for a successful Soundwave® installation.

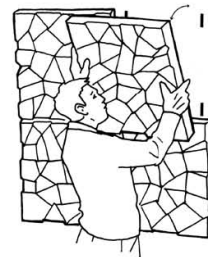
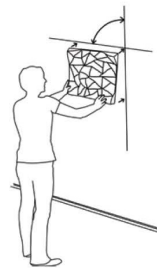
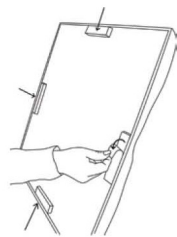
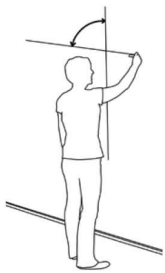

1. Read the instructions and plan the installation before starting. Avoid taking down the Velcro and restart, it will destroy the glue. If this happens it is possible to order new Velcro's.

2. Each panel has four Velcro attachments and it is very important that each point get under press while assemble, hold hand and press for min 10 sec.

3. For optimal assembly we recommend to attach the Velcro separate on the wall and press them firmly before putting on the panels.

4. Start putting the first panel on the centre of a horizontal line, laser level pass is recommended to have a perfect installation.

5. After putting all the panels to place, check that all Velcro attachments sticks to the wall. If not, press a longer time for each point until it attach to the wall.

Care instructions.

- If your panels get dusty, use a soft brush for cleaning. Brush gently from the top and downwards for the best result. You can also use a vacuum cleaner with an upholstery nozzle or a dusting brush. Set the vacuum cleaner on low suction to avoid damage of the surface.
- If your panels get stained, we recommend you to contact a professional cleaning company.